



Flat 2, 325 London Road, Hadleigh SS7 2BT

1 bedroom first floor flat / £750 pcm / t. 01702 555888

amos

An exciting opportunity to rent a luxury recently built **one bedroom** first floor apartment within the heart of Hadleigh Town Centre. Offering a lounge incorporating modern fitted kitchen, one bedroom, three piece bathroom suite and allocated parking. Available January.

Find us on



**A space to
call home.**

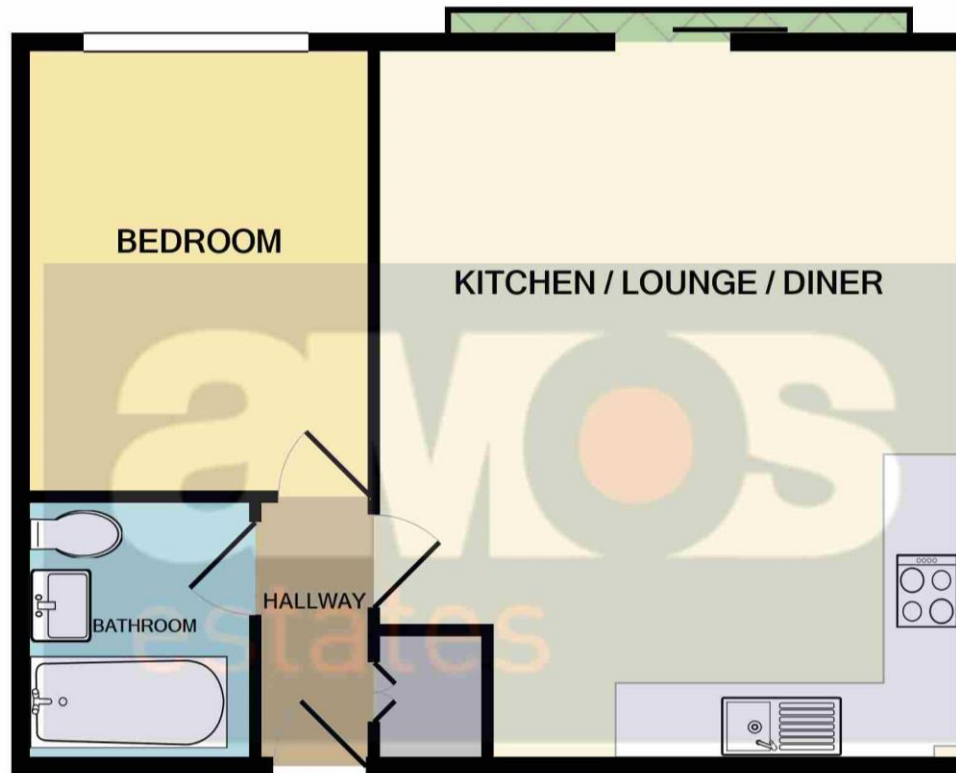

TOTAL APPROX. FLOOR AREA 483 SQ.FT. (44.9 SQ.M.)

Whilst every attempt has been made to ensure the accuracy of the floor plan contained here, measurements of doors, windows, rooms and any other items are approximate and no responsibility is taken for any error, omission, or mis-statement. This plan is for illustrative purposes only and should be used as such by any prospective purchaser. The services, systems and appliances shown have not been tested and no guarantee as to their operability or efficiency can be given

Made with Metropix ©2021



Highlights

- / One Bedroom First Floor Apartment**
- / Lounge Incorporating Kitchen 19'3 x 13'3**
- / Bedroom 12' x 9'5**
- / Bathroom 6'8 x 6'5**
- / Allocated Parking Space**
- / uPVC Double Glazing Throughout**
- / Gas Central Heating Via Combination Boiler**
- / Nest Temperature Control**
- / Video Entry System**
- / Available January**
- / Full Referencing Required**
- / No Pets**
- / EPC Band B**

**Lounge Incorporating Kitchen **

19'3 x 13'3

Lounge area with double glazed patio doors to Juliet balcony, fitted carpet, two radiators, power points. The kitchen area comprises modern white high gloss units to eye and base level with square edge work surfaces over with inset stainless steel one and a half bowl sink and drainer unit, integrated hob with cooker below and extractor hood above, power points, wood effect flooring.

**Bedroom **

12' x 9'5

Double glazed window, fitted carpet, power points, radiator.

**Bathroom **

6'8 x 6'5

Modern three piece suite comprising panelled bath with shower above and glass screen door, vanity wash basin, low flush WC, heated towel rail, tiled walls, wood effect flooring.

**Outside **

Allocated parking space.

**Available January \ Full Referencing Required \ No Pets \ EPC Band B **



at the heart of property.

Our professional and personal approach to property isn't just limited to residential sales. With a thriving commercial team, a dedicated mortgages expert and the longest established lettings and management department in Hadleigh and Hockley, we offer clients an exceptional experience, no matter what service they need.

Hadleigh Office: 319 London Road, Essex SS7 2BN **t:** 01702 555 888 **e:** hadleigh@amosstates.com

Hockley Office: 1A Spa Road, Hockley, Essex, SS5 4AZ **t:** 01702 207 720 **e:** hockley@amosstates.com

amosstates.com