



Lyndbourne Court, Benfleet, Essex, SS7

1 Bed Ground Floor Flat / £650 PCM / t. 01702 555888





Available for rent in this popular development is this immaculate **one bedroom** ground floor flat which is ready to move in to and offers good size lounge open plan to modern fitted kitchen, bedroom and three piece bathroom suite together with allocated parking space and further visitor spaces.

Situated in this convenient location within close proximity to Tarpots shopping facilities and local amenities whilst also having excellent transport links nearby via A127/A13 trunk roads, bus routes and Benfleet Station.

Find us on

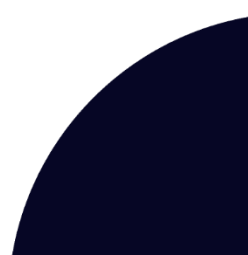

**A space to  
call home.**

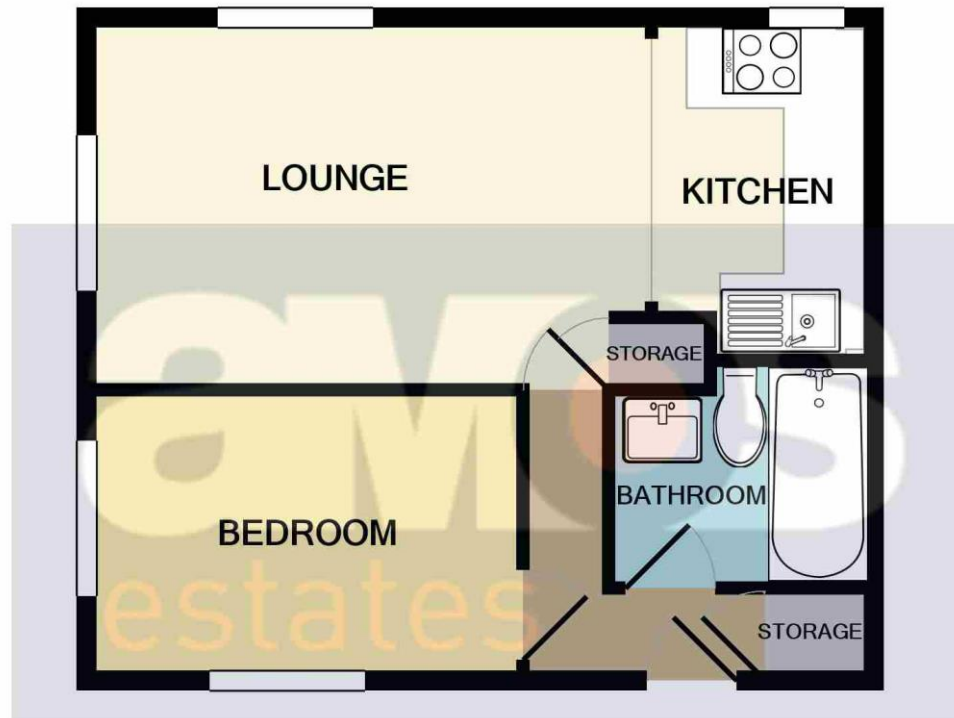

**TOTAL APPROX. FLOOR AREA 313 SQ.FT. (29.1 SQ.M.)**

Whilst every attempt has been made to ensure the accuracy of the floor plan contained here, measurements of doors, windows, rooms and any other items are approximate and no responsibility is taken for any error, omission, or mis-statement. This plan is for illustrative purposes only and should be used as such by any prospective purchaser. The services, systems and appliances shown have not been tested and no guarantee as to their operability or efficiency can be given

Made with Metropix ©2021



## Highlights

- / Lounge open plan to kitchen 20'6 x 9'2**
- / Bedroom 10'7 x 7'10**
- / Bathroom 6'5 x 5'8 Max**
- / Communal gardens**
- / Allocated parking space and further visitor space**
- / Well Presented Throughout**
- / Upvc Double Glazing Throughout**
- / Excellent Location**

Communal entrance door opening to communal hallway leading to private entrance door with spy hole to:

### **Entrance Hall \**

Laminate flooring, power points, wall mounted entry phone system, telephone point, storage cupboard with shelving, doors to accommodation off.

### **Lounge open plan to kitchen \**

20'6 x 9'2 (6.27m x 2.8m)

The lounge area having laminate flooring, power points, TV point, telephone point, uPVC double glazed windows to front and side, airing cupboard housing hot water tank, open plan to the kitchen. Modern kitchen comprising stainless steel sink and drainer unit inset into a range of square edge worktops with white high gloss cupboards and drawers beneath and matching eye level units, integrated Whirlpool electric oven with integrated Whirlpool microwave above, inset four ring Whirlpool electric hob, space and plumbing for dishwasher, space and plumbing for washing machine, power points, attractive tiling, laminate flooring, uPVC double glazed window to side.

### **Bedroom \**

10'7 x 7'10 (3.26m x 2.16m)

UPVC double glazed windows to front and side, laminate flooring, power points.



## **Bathroom \**

**6'5 x 5'8 Max (1.98m x 1.76m)**

Modern three piece suite comprising panel bath with chrome controls and shower over, push button W.C, vanity wash basin with chrome mixer tap and storage below, tiled floor, tiled walls, wall mounted heater, extractor fan, ladder style heated towel radiator.

## **Outside \**

The property benefits from well tended communal gardens and allocated parking space and further visitor spaces.

**Available End Of October \ No Pets As Per Lease \ Full Referencing Required \ EPC Band D**



## **PLEASE NOTE:-**

We recommend our customers use our panel of Conveyancers/Solicitors. It is your decision whether you choose to deal with our recommendation, and you are under no obligation to do so. You should know that we may receive a referral fee of £150 to £200 per transaction from them.

Should you arrange a Mortgage through our recommended mortgage advisor, again of which there is no obligation we will receive a commission fee. The amount of commission will depend on the size of the loan and any associated products that you decide to take.

### **The Consumer Protection from Unfair Trading Regulations 2008 (CPRs).**

These details are for guidance only and complete accuracy cannot be guaranteed. If there is any point, which is of particular importance, verification should be obtained. They do not constitute a contract or part of a contract. All measurements are approximate. No guarantee can be given with regard to planning permissions or fitness for purpose. No apparatus, equipment, fixture or fitting has been tested. Items shown in photographs are NOT necessarily included. Interested Parties are advised to check availability and make an appointment to view before travelling to see a property.



# at the heart of property.

Our professional and personal approach to property isn't just limited to residential sales. With a thriving commercial team, a dedicated mortgages expert and the longest established lettings and management department in Hadleigh and Hockley, we offer clients an exceptional experience, no matter what service they need.

**Hadleigh Office:** 319 London Road, Essex SS7 2BN **t:** 01702 555 888 **e:** hadleigh@amosstates.com

**Hockley Office:** 1A Spa Road, Hockley, Essex, SS5 4AZ **t:** 01702 207 720 **e:** hockley@amosstates.com

[amosstates.com](https://amosstates.com)