

# KEY FACTS FOR BUYERS

**Chetney View, Sittingbourne, ME9**

September 2021



## A guide to this property and the local area

### Harrison Homes

2 West Street, Sittingbourne, Kent, ME10 1AW

01795 474848

[chris@harrisonshomes.co.uk](mailto:chris@harrisonshomes.co.uk)

[www.harrisonshomes.co.uk/about/](http://www.harrisonshomes.co.uk/about/)



# PROPERTY OVERVIEW

## CHETNEY VIEW, SITTINGBOURNE, ME9



 Boundary (Land Registry Title Plan)



### PROPERTY KEY FACTS

Detached House  
5 Bedrooms

Floor Area: 1,732.99 ft<sup>2</sup>  
161.00 m<sup>2</sup>

Plot Size: 0.09 acres

Council Tax Band: F

Annual Cost: £2,747.41 (min)

Land Registry Title Number: K856786

Tenure: Freehold

### AREA KEY FACTS

Local Authority: SWALE

Flood Risk: Very Low

Conservation Area: No

Predicted Broadband Speeds

Basic: 2 Mbps

Superfast: 80 Mbps

Ultrafast: 600 Mbps

Mobile Coverage  
(based on voice calls made indoors)

EE: 

Three: 

O2: 

Vodafone: 

Satellite / Fibre TV Availability

BT: 

Sky: 

Virgin: 

### PLANNING HISTORY

No Planning Records Available

### Harrison Homes

2 West Street, Sittingbourne, Kent, ME10 1AW  
01795 474848  
chris@harrisonshomes.co.uk  
www.harrisonshomes.co.uk/about/



# PROPERTY OVERVIEW

## PHOTO GALLERY



### Harrison Homes

2 West Street, Sittingbourne, Kent, ME10 1AW  
01795 474848  
[chris@harrisonshomes.co.uk](mailto:chris@harrisonshomes.co.uk)  
[www.harrisonshomes.co.uk/about/](http://www.harrisonshomes.co.uk/about/)



# PROPERTY OVERVIEW

## PHOTO GALLERY



### Harrison Homes

2 West Street, Sittingbourne, Kent, ME10 1AW  
01795 474848  
[chris@harrisonshomes.co.uk](mailto:chris@harrisonshomes.co.uk)  
[www.harrisonshomes.co.uk/about/](http://www.harrisonshomes.co.uk/about/)



# PROPERTY OVERVIEW

## PHOTO GALLERY



### Harrison Homes

2 West Street, Sittingbourne, Kent, ME10 1AW  
01795 474848  
[chris@harrisonshomes.co.uk](mailto:chris@harrisonshomes.co.uk)  
[www.harrisonshomes.co.uk/about/](http://www.harrisonshomes.co.uk/about/)

# PROPERTY OVERVIEW

## PHOTO GALLERY



### Harrison Homes

2 West Street, Sittingbourne, Kent, ME10 1AW  
01795 474848  
[chris@harrisonshomes.co.uk](mailto:chris@harrisonshomes.co.uk)  
[www.harrisonshomes.co.uk/about/](http://www.harrisonshomes.co.uk/about/)



# PROPERTY OVERVIEW

## FLOORPLANS

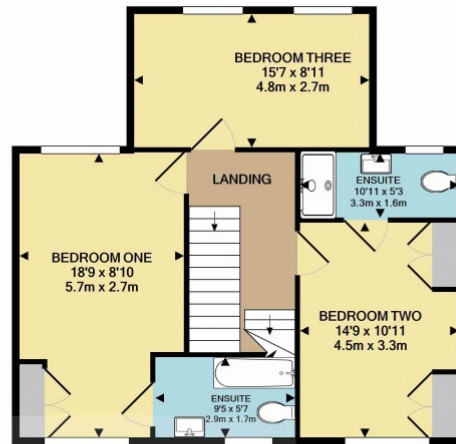

**TOTAL APPROX. FLOOR AREA 1827 SQ.FT. (169.7 SQ.M.)**

Whilst every attempt has been made to ensure the accuracy of the floor plan contained here, measurements of doors, windows, rooms and any other items are approximate and no responsibility is taken for any error, omission, or mis-statement. This plan is for illustrative purposes only and should be used as such by any prospective purchaser. The services, systems and appliances shown have not been tested and no guarantee as to their operability or efficiency can be given.

Made with Metropix 5/2021

### Harrison Homes

2 West Street, Sittingbourne, Kent, ME10 1AW  
01795 474848  
chris@harrisonshomes.co.uk  
[www.harrisonshomes.co.uk/about/](http://www.harrisonshomes.co.uk/about/)

# PROPERTY OVERVIEW

## EPC

Chetney View, Iwade, ME9

Energy rating

**C**

Valid until 02.03.2026

Score	Energy rating	Current	Potential
92+	<b>A</b>		
81-91	<b>B</b>		
69-80	<b>C</b>		81   <b>B</b>
55-68	<b>D</b>	70   <b>C</b>	
39-54	<b>E</b>		
21-38	<b>F</b>		
1-20	<b>G</b>		

### Harrison Homes

2 West Street, Sittingbourne, Kent, ME10 1AW  
01795 474848  
chris@harrisonshomes.co.uk  
[www.harrisonshomes.co.uk/about/](http://www.harrisonshomes.co.uk/about/)



# LOCAL AREA

## NEARBY SCHOOLS & RATINGS

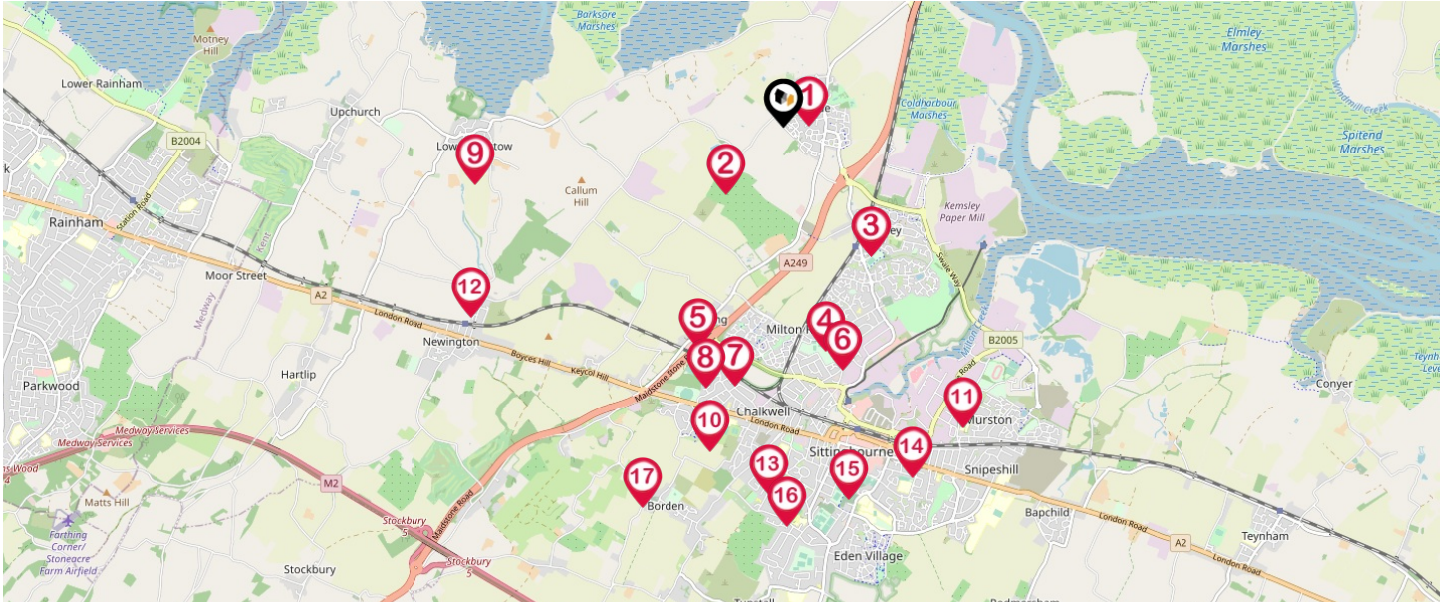

Pin	School Details	Rating	Pupils	Distance	Nursery	Primary	Secondary	College	Private
1	Iwade School	Good	599	0.22 Miles	<input type="checkbox"/>	<input checked="" type="checkbox"/>	<input type="checkbox"/>	<input type="checkbox"/>	<input type="checkbox"/>
2	Brogdale Community Interest Company	Requires improvement	-	-	<input type="checkbox"/>	<input type="checkbox"/>	<input type="checkbox"/>	<input checked="" type="checkbox"/>	<input type="checkbox"/>
3	Kemsley Primary Academy	Good	252	1.17 Miles	<input checked="" type="checkbox"/>	<input checked="" type="checkbox"/>	<input type="checkbox"/>	<input type="checkbox"/>	<input type="checkbox"/>
4	Regis Manor Primary School	Good	487	1.69 Miles	<input checked="" type="checkbox"/>	<input checked="" type="checkbox"/>	<input type="checkbox"/>	<input type="checkbox"/>	<input type="checkbox"/>
5	Bobbing Village School	Outstanding	208	1.73 Miles	<input type="checkbox"/>	<input checked="" type="checkbox"/>	<input type="checkbox"/>	<input type="checkbox"/>	<input type="checkbox"/>
6	Milton Court Primary Academy	Good	210	1.85 Miles	<input checked="" type="checkbox"/>	<input checked="" type="checkbox"/>	<input type="checkbox"/>	<input type="checkbox"/>	<input type="checkbox"/>
7	Aspire School	-	-	-	<input type="checkbox"/>	<input checked="" type="checkbox"/>	<input type="checkbox"/>	<input type="checkbox"/>	<input type="checkbox"/>
8	Grove Park Primary School	Good	423	2 Miles	<input type="checkbox"/>	<input checked="" type="checkbox"/>	<input type="checkbox"/>	<input type="checkbox"/>	<input type="checkbox"/>
9	Lower Halstow Primary School	Good	158	2.29 Miles	<input type="checkbox"/>	<input checked="" type="checkbox"/>	<input type="checkbox"/>	<input type="checkbox"/>	<input type="checkbox"/>
10	Westlands School	Good	1648	2.44 Miles	<input type="checkbox"/>	<input type="checkbox"/>	<input checked="" type="checkbox"/>	<input checked="" type="checkbox"/>	<input type="checkbox"/>
11	Sunny Bank Primary School	-	-	-	<input checked="" type="checkbox"/>	<input checked="" type="checkbox"/>	<input type="checkbox"/>	<input type="checkbox"/>	<input type="checkbox"/>
12	Newington Church of England Primary School	Good	185	2.68 Miles	<input type="checkbox"/>	<input checked="" type="checkbox"/>	<input type="checkbox"/>	<input type="checkbox"/>	<input type="checkbox"/>
13	Westlands Primary School	Good	564	2.7 Miles	<input type="checkbox"/>	<input checked="" type="checkbox"/>	<input type="checkbox"/>	<input type="checkbox"/>	<input type="checkbox"/>
14	VTC Independent School	-	-	-	<input type="checkbox"/>	<input type="checkbox"/>	<input checked="" type="checkbox"/>	<input checked="" type="checkbox"/>	<input type="checkbox"/>
15	Borden Grammar School	Good	829	2.79 Miles	<input type="checkbox"/>	<input type="checkbox"/>	<input checked="" type="checkbox"/>	<input checked="" type="checkbox"/>	<input type="checkbox"/>
16	St Peter's Catholic Primary School	-	209	2.94 Miles	<input type="checkbox"/>	<input checked="" type="checkbox"/>	<input type="checkbox"/>	<input type="checkbox"/>	<input type="checkbox"/>
17	Borden Church of England Primary School	-	135	2.98 Miles	<input type="checkbox"/>	<input checked="" type="checkbox"/>	<input type="checkbox"/>	<input type="checkbox"/>	<input type="checkbox"/>

### Harrison Homes

2 West Street, Sittingbourne, Kent, ME10 1AW  
 01795 474848  
[chris@harrisonshomes.co.uk](mailto:chris@harrisonshomes.co.uk)  
[www.harrisonshomes.co.uk/about/](http://www.harrisonshomes.co.uk/about/)

# LOCAL AREA

## NEAREST TRANSPORT LINKS

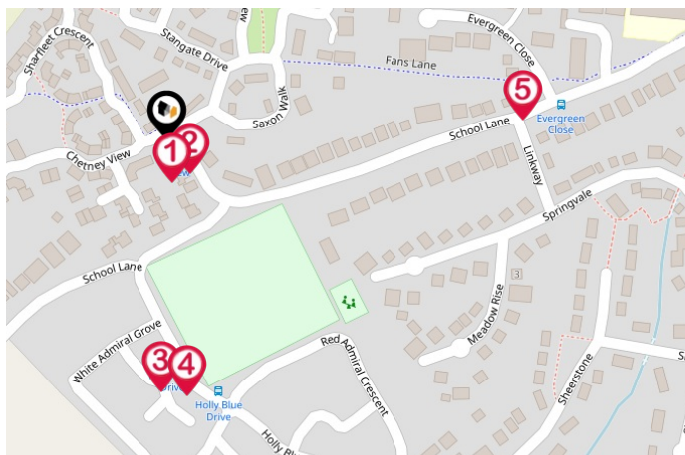

### BUS STOPS/STATIONS

- 1 - Chetney View | 0.02 miles
- 2 - Chetney View | 0.02 miles
- 3 - Holly Blue Drive | 0.12 miles
- 4 - Holly Blue Drive | 0.12 miles
- 5 - Evergreen Close | 0.17 miles

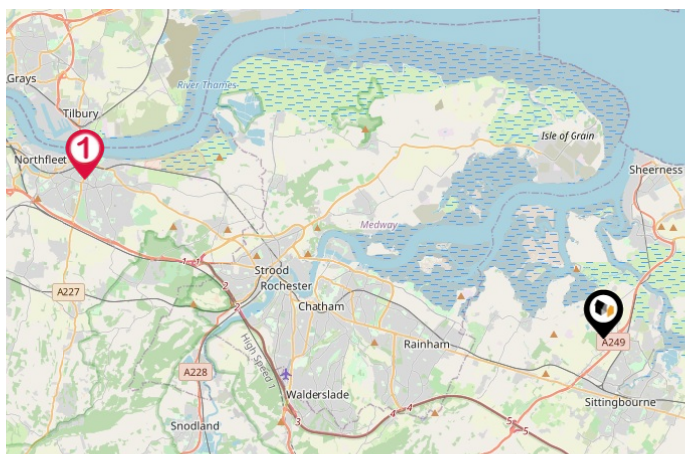

### FERRY TERMINALS

- 1 - Town Pier | 15.95 miles

### Harrison Homes

2 West Street, Sittingbourne, Kent, ME10 1AW  
01795 474848  
[chris@harrisonshomes.co.uk](mailto:chris@harrisonshomes.co.uk)  
[www.harrisonshomes.co.uk/about/](http://www.harrisonshomes.co.uk/about/)



## LOCAL AREA

## NEAREST TRANSPORT LINKS

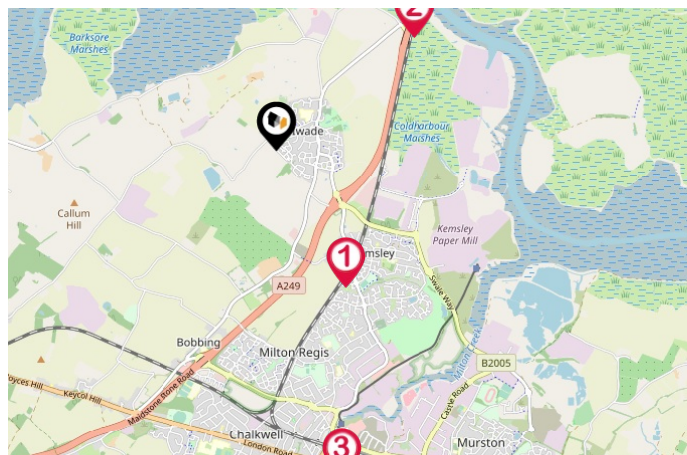

## NATIONAL RAIL STATIONS

- 1 - Kemsley Rail Station | 1.15 miles
- 2 - Swale Rail Station | 1.35 miles
- 3 - Sittingbourne Rail Station | 2.48 miles

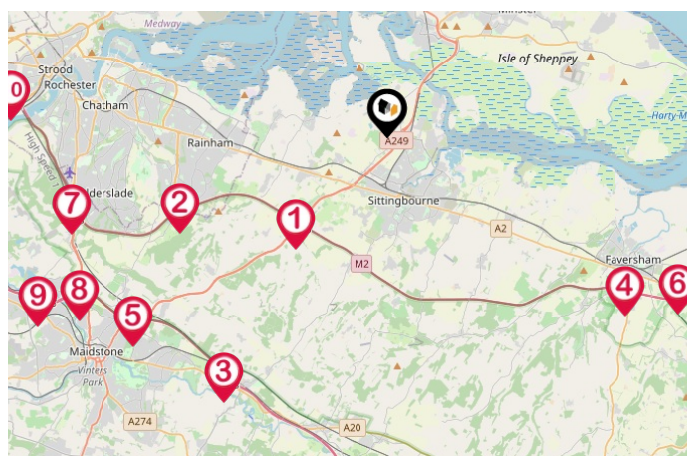

## TRUNK ROADS/MOTORWAYS

- 1 - M2 J5 | 4.17 miles
- 2 - M2 J4 | 6.63 miles
- 3 - M20 J8 | 9.13 miles
- 4 - M2 J6 | 8.91 miles
- 5 - M20 J7 | 9.63 miles
- 6 - M2 J7 | 10.2 miles
- 7 - M2 J3 | 9.64 miles
- 8 - M20 J6 | 10.48 miles
- 9 - M20 J5 | 11.66 miles
- 10 - M2 J2 | 11.04 miles

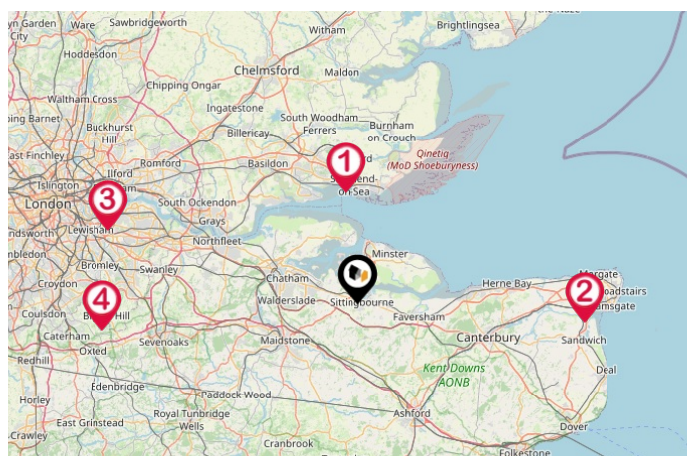

## AIRPORTS/HELIPADS

- 1 - London Southend Airport | 13.3 miles
- 2 - Kent International Airport | 27.53 miles
- 3 - London City Airport | 30.29 miles
- 4 - Biggin Hill Airport | 29.93 miles

## Harrison Homes

2 West Street, Sittingbourne, Kent, ME10 1AW  
01795 474848  
chris@harrisonshomes.co.uk  
[www.harrisonshomes.co.uk/about/](http://www.harrisonshomes.co.uk/about/)

Powered by



# LOCAL MARKET

## HOUSE PRICE STATISTICS FOR ME9

### 10 YEAR HISTORY OF AVERAGE PRICES BY PROPERTY TYPE

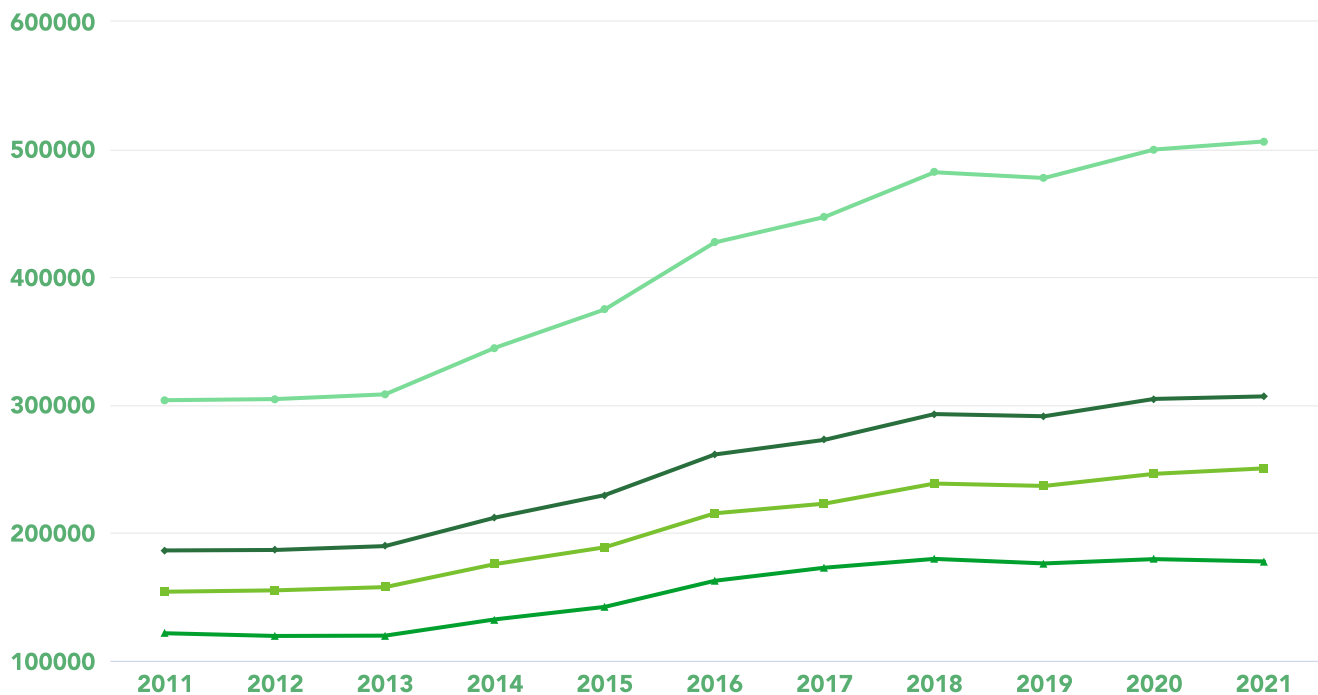

**FLAT**  
+ 46.19%



**TERRACED**  
+ 62.59%



**SEMI-DETACHED**  
+ 64.64%



**DETACHED**  
+ 66.59%

#### Harrison Homes

2 West Street, Sittingbourne, Kent, ME10 1AW  
01795 474848  
chris@harrisonshomes.co.uk  
[www.harrisonshomes.co.uk/about/](http://www.harrisonshomes.co.uk/about/)



# HARRISON HOMES

## About Us

We are proud members of NAEA Propertymark, who promote the highest standards in residential sales. Simply put, we have the highest expectations for the service we deliver.

Whatever you need, whatever your situation, we personalise our service to make it specific to you. You will discover that we're not about the sale but the experience.

## Financial Services

Our mortgage advisor partners Henchurch Lane, have a point to prove to their clients and the industry as a whole. They're extremely passionate about what they do and believe there is a better way to offer advice to the masses in comparison to what's currently on offer elsewhere. They pride ourselves on alleviating the stresses of the mortgage and insurance application process by offering anti-jargon advice to help navigate the hundreds of deals and criteria pitfalls that exist in today's market place.

### Harrison Homes

2 West Street, Sittingbourne, Kent, ME10 1AW  
01795 474848  
[chris@harrisonshomes.co.uk](mailto:chris@harrisonshomes.co.uk)  
[www.harrisonshomes.co.uk/about/](http://www.harrisonshomes.co.uk/about/)

# DATA QUALITY

Harrison Homes is committed to comprehensive property data being made available upfront to make the home buying and selling process quicker, easier and cheaper. Which is why they have partnered with Sprift, the UK's leading supplier of property specific data.

## Data Partners:



Contains public sector information licensed under the Open Government Licence v3.0

The information contained in this report is for general information purposes only and to act as a guide to the best way to market your property and the asking price.

Sprift Technologies Limited aggregate this data from a wide variety of sources and while we endeavour to keep the information up to date and correct, we make no representations or warranties of any kind, express or implied, about the completeness, accuracy, reliability, of the information or related graphics contained in this report for any purpose. Any reliance you place on such information is therefore strictly at your own risk. In no event will we be liable for any loss or damage including without limitation, indirect or consequential loss or damage, or any loss or damage whatsoever arising from loss of data or profits arising out of, or in connection with, the use of this report.

Information produced by HM Land Registry. Crown copyright and database rights 2021